



GENERAL INFORMATION

The ETC ColorSource PAR offers a quality of build and light that has never been seen in an affordable wash fixture before. Using ETC’s unique RGB-L colour system, the ColorSource PAR provides a rich, bright light unlike any other LED washlight in its class. And it’s made in the U.S.A.

APPLICATIONS

- Houses of worship
- Smaller theatrical venues
- Universities and schools
- General illumination
- Hospitality
- Retail
- Exhibition centres
- Meeting rooms
- Clubs
- Cafetoriums

PRODUCT FEATURES

- ETC’s new RGB-L chipset (Red, Green, Blue and Lime)
- Homogenised optics
- Simple user interface with 7-segment display
- Control just as any simple RGB fixture (Lime colour calculated via advanced internal algorithm)
- PowerCON in and thru connectors
- DMX/RDM in and thru via XLR5 connectors
- Factory calibrated
- LED droop compensation
- Tour-ready, aluminium housing
- Designed and built in the USA

ORDERING INFORMATION

ColorSource PAR

PART NO	DESCRIPTION
7412A1205	ColorSource PAR, Black
7412A1205-1	ColorSource PAR, White
7412A1205-5	ColorSource PAR, Silver Grey
7412A1205-8	ColorSource PAR, CC

Note: ColorSource PAR luminaires are shipping with hanging yoke and 1.5m PowerCON to bare ends power cable.

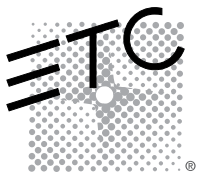

## SPECIFICATIONS

## GENERAL

- 8 RGB-L chipset colour-mixing wash luminaire
- CE compliant and ETL Listed to UL1573.
- IP20-rated for indoor use
- Power- and DMX-in/thru connections for easy setup
- Simple 7-segment, three-button interface with easy access to 12 customisable presets and 5 sequences

## PHYSICAL

- Rugged, die-cast, all-metal housing
- Easy-access slots for secondary lenses and 190mm accessories (Similar to Desire D40)
- Available in black, white, silver grey) or custom colours  
Contact your ETC dealer for quotation.
- Hanging yoke included

## ELECTRICAL

- 100VAC to 240VAC 50/60Hz universal power input
- Max. power consumption 230V at full intensity 0.4A / 89W
- PowerCON in and thru connections
- Up to 9 luminaires (15A max) may be linked via power thru connector (10 luminaires total per circuit) when used with ETC Sensor or Unison Relay modules. Equipment supplied by others are likely to support no more than 6 fixtures per circuit. Please examine breaker trip curves for further information.
- Inrush current at 230V: 49A (First half-cycle only)

## LED\*

- 20,000-hour LED life (20,000 hours at 70% intensity)
- 40 Luxeon® Z LED emitters (five per optical segment)

\*See additional LED notes on page 3

## COLOUR

- Exclusive RGB-L Color array
- Brightness and colour range unlike any other 4-colour system
- Droop compensation maintains colour accuracy during use
- Optically calibrated to ensure consistency across fixtures

## OPTICAL

- Primary field angle of 24.9° and beam angle of 14.5°
- Secondary lenses (D40 range) available for multiple beam-spread options
- Homogenised optics for a consistent, smooth beam
- Refer to accessories charts for lenses available

## CONTROL

- DMX512 in and thru via five-pin XLR connectors (termination required)
- RGB control (See DMX control table for additional information)
- 15-bit virtual dimming engine provides smooth, high-quality theatrical fades
- RDM functionality for address and setting changes
- Local control of presets (12) and sequences (5)

## THERMAL

- Ambient operating temperature 0° to 40°C
- Active electronic thermal management for thermal droop-free operation
- Variable-speed fan
- Fixture is designed for continuous operation up to 40°C ambient temperature and requires free flow of air around fixture housing

## ADDITIONAL ORDERING INFORMATION

## Power Thru jumper cables

Note: Connect to fixture's output (thru) connector to provide link to successive fixtures.

PART NO	DESCRIPTION
7410B7013	1.8m PowerCON to bare ends power input cable (Spare)
7410K1101	1m PowerCON to bare ends power thru cable 3x1mm2
7410K1102	1m PowerCON to PowerCON fixture to fixture jumper cable 3x1mm2
7410K1103	2m PowerCON to PowerCON fixture to fixture jumper cable 3x1mm2
7410K1104	5m PowerCON to PowerCON fixture to fixture jumper cable 3x1mm2
7410K1105	1m fixture-to-fixture twin jumper cable with both power and DMX (XLR5) connectors
7410K1106	1m fixture-to-fixture twin jumper cable with both power and DMX (XLR5) connectors
7410K1107	1m fixture-to-fixture twin jumper cable with both power and DMX (XLR5) connectors

## Luminaire Accessories

PART NO	DESCRIPTION
7412K1000	ColorSource PAR Floorstanding Yoke Combo, Black
PSF1095*	Barn door, Short, Black (Use only as a flexible top hat to diminish aperture glare. Not for beam shaping)
7061A3007*	Media Frame, Black 190mm x 190mm (use for round and oblong lenses)
PSF1028*	Egg Crate Louvre, Black
PSF1022*	Top Hat with 76mm Tube, Black
PSF1023*	Top Hat with 153mm Tube, Black
PSF2017*	Half Hat with 153mm Tube, Black

Notes: For accessories in other colours than black, use -1 for white and -5 for silver grey when ordering.

\* ColorSource PAR is sharing accessories with Desire D40 except for Floorstanding Yoke.

PHOTOMETRICS

ColorSource PAR

Mode	Degree	Candela	Field Lumens	Beam Lumens	Lumens Per Watt
Regulated - RGB	24.9	47,900	2,749	1,537	32

Metric conversions: For meters, multiply feet by 0.3048  
For lux, multiply footcandles by 10.76

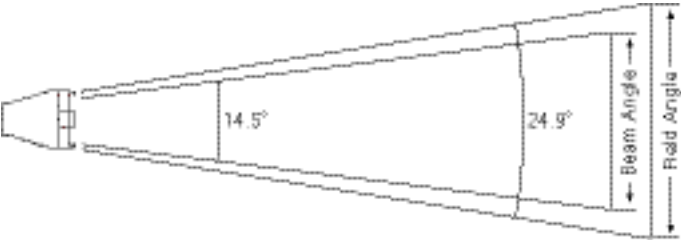

Throw Distance (d)	3.0m	4.6m	6.1m	7.6m
Field Diameter	1.3m	2.0m	2.7m	3.4m
Illuminance (fc)	474	211	119	76
Illuminance (lux)	5,102	2,268	1,276	816

To determine centre beam illumination in footcandles at any throw distance, divide candela by the throw distance squared

For field diameter at any distance, multiply distance by 0.442

For beam diameter at any distance, multiply by 0.254

ADDITIONAL ORDERING INFORMATION

Secondary Lens Options

**NOTE:** The following lenses are cut for ColorSource luminaires and create round, linear or oblong field patterns as described below. These lenses are *not* sized for use in Selador® Classic fixtures. Frame included for round and oblong lenses, but not needed for linear lenses

PART NO	DESCRIPTION
<b>Linear Field</b>	Note: This is the same material as Selador Classic lenses
7410K1017	Ø190mm 20° (linear field)
7410K1018	Ø190mm 30° (linear field)
7410K1019	Ø190mm 40° (linear field)
7410K1020	Ø190mm 50° (linear field)
7410K1021	Ø190mm 80° (linear field)
<b>Round Field</b>	
7410K1010	190x190mm Very Narrow lens (round field)
7410K1011	190x190mm Narrow lens (round field)
7410K1012	190x190mm Medium lens (round field)
7410K1013	190x190mm Wide lens (round field)
7410K1039	190x190mm Xtra-Wide lens (round field)
<b>Oblong Field</b>	
7410K1014	Ø190mm Narrow lens (oblong/oval field)
7410K1015	Ø190mm Medium lens (oblong/oval field)
7410K1016	Ø190mm Wide lens (oblong/oval field)

Desire lenses compared to Source Four PAR EA

Typical Lens Field Profiles

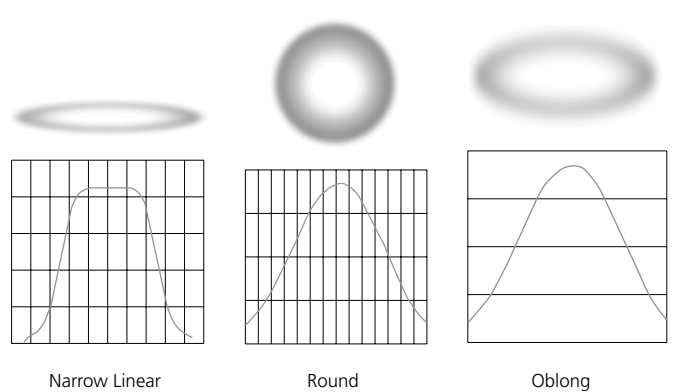

NOTES ABOUT LED LUMINAIRES

All LED sources experience some lessening of light output and some colour shift over time. LED output will vary with thermal conditions. Thermal conditions can be affected by ambient temperatures and orientation. Based on the LED manufacturer's B50 L70 specification, a ColorSource luminaire will achieve ~70% of its initial output after 20,000 hours of typical usage. In individual situations, LEDs will be used for different durations and at different levels. This can eventually lead to minor alterations in color performance, necessitating slight adjustments to presets, cues or programs.

CONTROL

DMX Input Channel Profiles

DMX Profile	DMX Channels	Channel Assignments	Notes
RGB	5	1-INT 2-Red 3-Green 4-Blue 5-Strobe	

PHYSICAL

ColorSource PAR Dimensions

HEIGHT	WIDTH	DEPTH
mm	mm	mm
310	203	240

\* Does not include mounting hardware

ColorSource PAR Weights

WEIGHT*	SHIPPING WEIGHT
kgs	kgs
3.8	4.6

\* Does not include mounting hardware

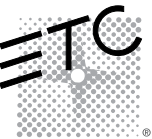
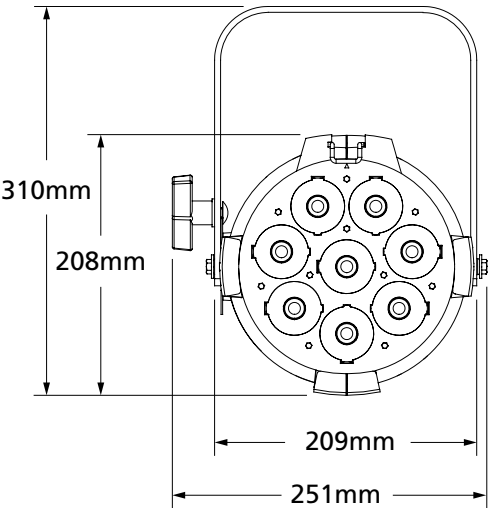
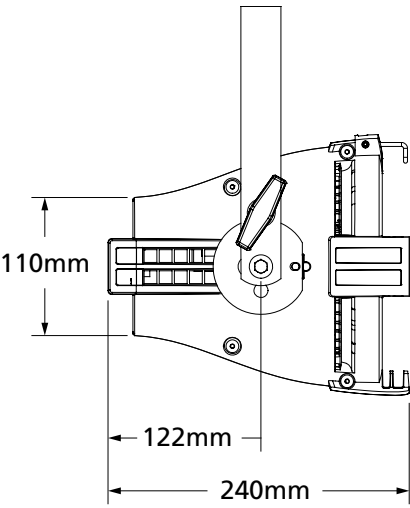
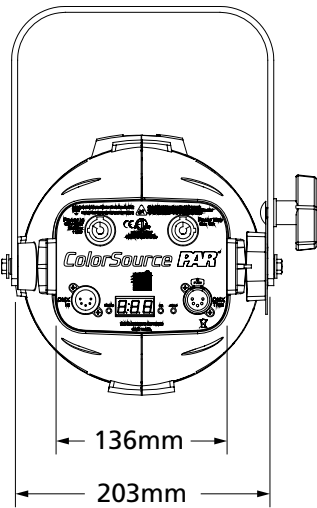

Corporate Headquarters • 3031 Pleasant View Rd, PO Box 620979, Middleton WI 53562 0979 USA • Tel +1 608 831 4116 • Fax +1 608 836 1736  
London, UK • Unit 26-28, Victoria Industrial Estate, Victoria Road, London W3 6UU, UK • Tel +44 (0)20 8896 1000 • Fax +44 (0)20 8896 2000  
Rome, IT • Via Pieve Torina, 48, 00156 Rome, Italy • Tel +39 (06) 32 111 683 • Fax +44 (0)20 8752 8486  
Holzkirchen, DE • Ohmstrasse 3, 83607 Holzkirchen, Germany • Tel +49 (80 24) 47 00-0 • Fax +49 (80 24) 47 00-3 00  
Hong Kong • Room 1801, 18/F, Tower 1 Phase 1, Enterprise Square, 9 Sheung Yuet Road, Kowloon Bay, Kowloon, Hong Kong • Tel +852 2799 1220 • Fax +852 2799 9325  
Web • [www.etconnect.com](http://www.etconnect.com) • Copyright©2015 ETC. All Rights Reserved. All product information and specifications subject to change. 7412L1000-GB Rev. B 04/2015

This product is protected by one or more of the following U.S. Patents: 6,016,038, 6,150,774, 6,788,011, 6,806,659, 6,683,423 and 7,023,543